



Swath Width

Written By: Support

The screenshot displays the Farmobile mobile application interface. On the left is a grey sidebar with a menu containing options like "Machines", "Fields", "Notes", "File Transfer", "Data Import", "Reports", "Downloads", "Inputs", "Account", "Farmobile Shop", and "How-To Guides". The "Machines" option is highlighted with an orange bar. The main content area is titled "Harvesting Demo PUC" and shows a summary card for a machine named "Harvesting Demo PUC" with details like "Farmobile Support", "Firmware 01.32", and "MAC DEMOMAC5". Below this is a "LIVE" status indicator, a clock icon, and an "Export" button. A timeline shows an event at "09:56 AM - Startup" with a dropdown menu set to "Harvesting". The "Swath Width" settings are highlighted with an orange box and an arrow pointing to it from the left. These settings include a checked checkbox for "Machine detected swath width", a "Source: Machine Detected" label, a "PUC Centerline Offset" field with a "feet" unit and "Left/Right" radio buttons, an "Implement Offset" field with a "feet" unit and "Rear/Front" radio buttons, a "Crop Type" dropdown set to "Corn", and another "Source: Machine Detected" label. At the bottom of the settings are "Save" and "Cancel" buttons. The right side of the screen shows a satellite map of a field with a green swath width overlay. A speedometer at the bottom indicates "Speed - mph" with a scale from 0 to 70.

INTRODUCTION

- History Machine Adjustments are only available at the Machine level.
- Swath Width adjustments are available for all activity types.
- Swath Width Adjustments carry forward to the end of the year or up to the next user entered swath width adjustment.
 - Per 'Activity' type.
 - Per PUC.
- When Foraging or Harvesting the swath width source will either be 'Machine Detected' or 'User Defined'.
 - Machine Detected: While Harvesting the PUC captured the swath width from the machine. To override these values, un-check the 'Machine detected swath width' checkbox and type in the required swath width value.
 - User Defined: While Harvesting, a user provided the swath width. Adjust that value by typing in the correct swath width.

Step 1 — Select Machines from the Farmobile DataEngineSM Menu

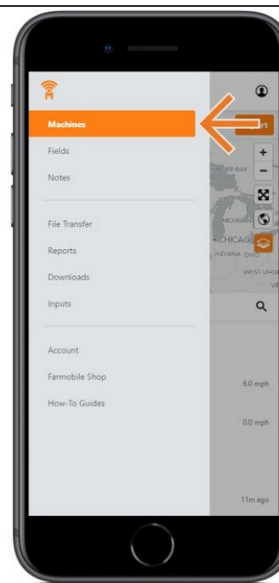
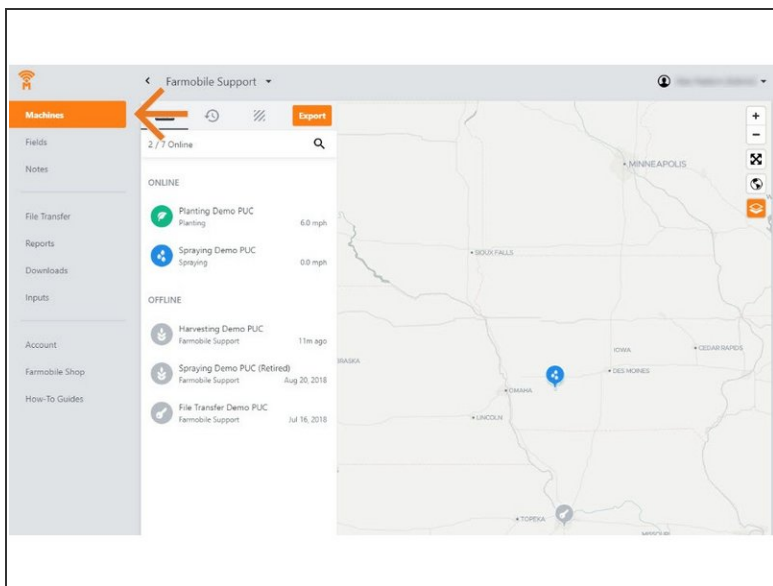

- Selecting Machines from the Farmobile DataEngine menu will open the Machines page with all of your PUCTM listed and displayed on the map.

Step 2 — Select a Machine

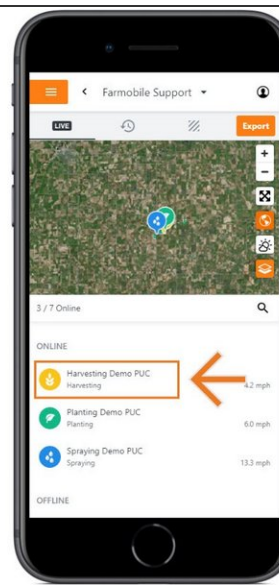
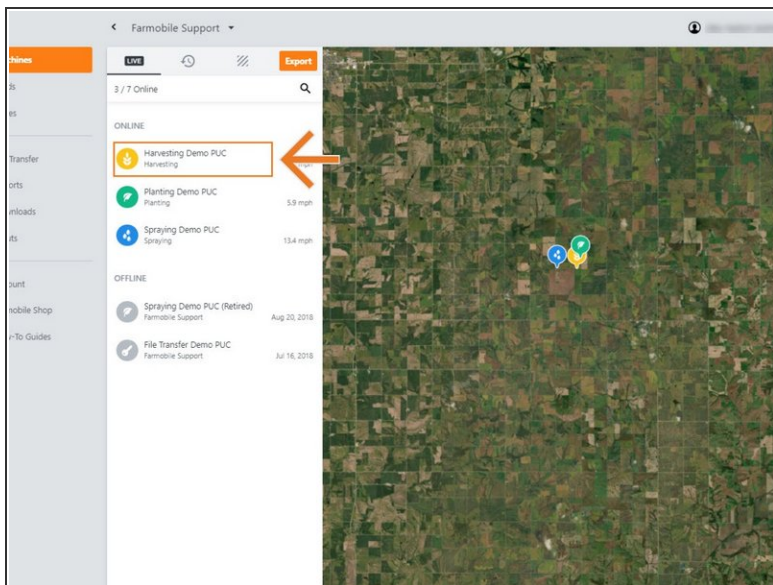

- Select a machine to open the machine details page.

Step 3 — Select History

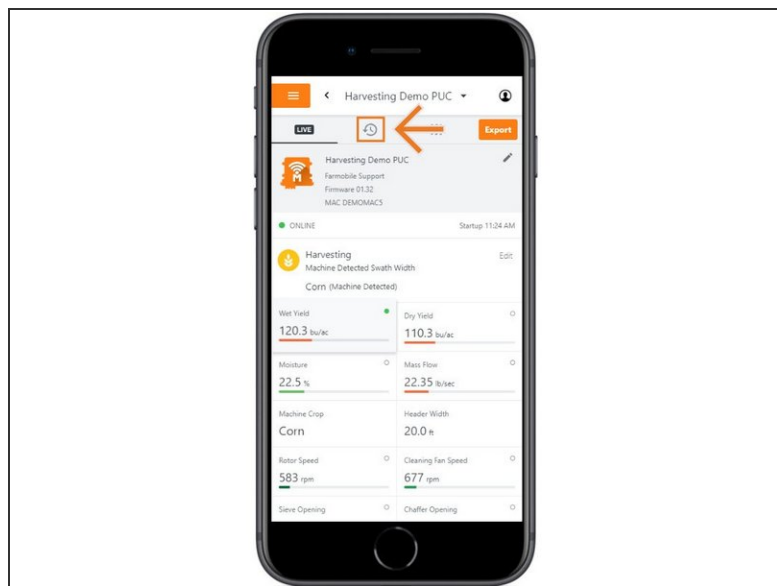
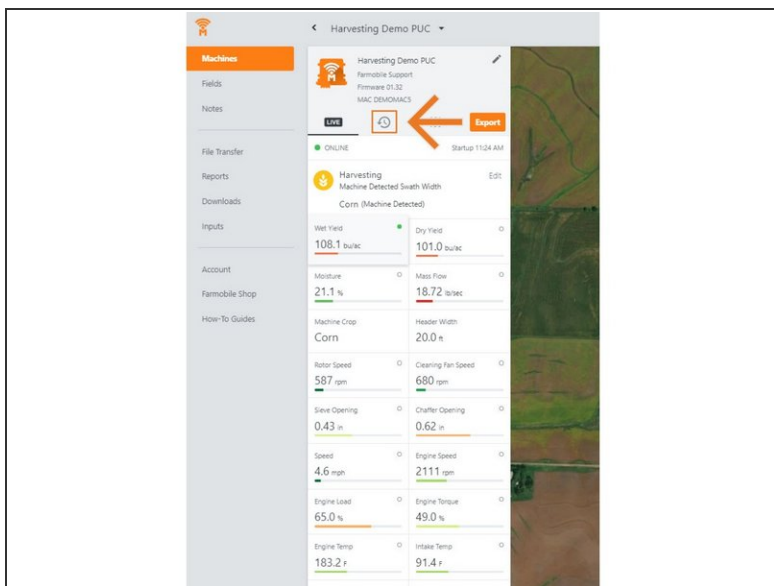

- Select the History tab to open the history page for the selected machine.
- The History page will open with the last active day selected.

Step 4 — Select Day and Edit

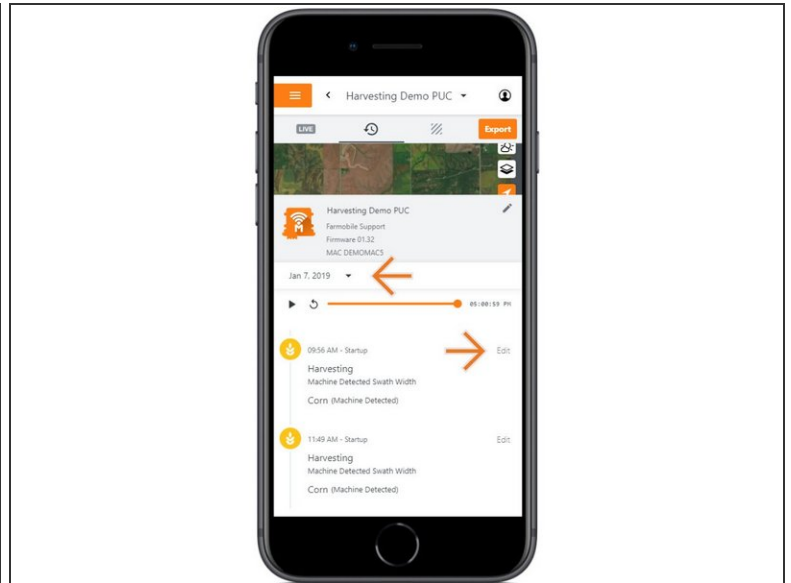
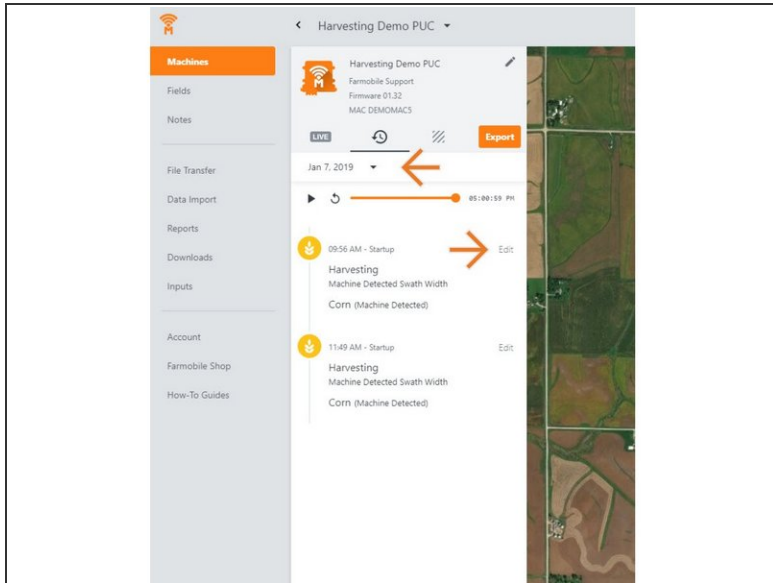

- Select the calendar picker to view a different day. Days containing Machine History are highlighted black.
- Select edit to expand the adjustment options within the required session.
- The available options to adjust vary based on the current activity type.

Step 5 — Make Swath Width Adjustment and Save

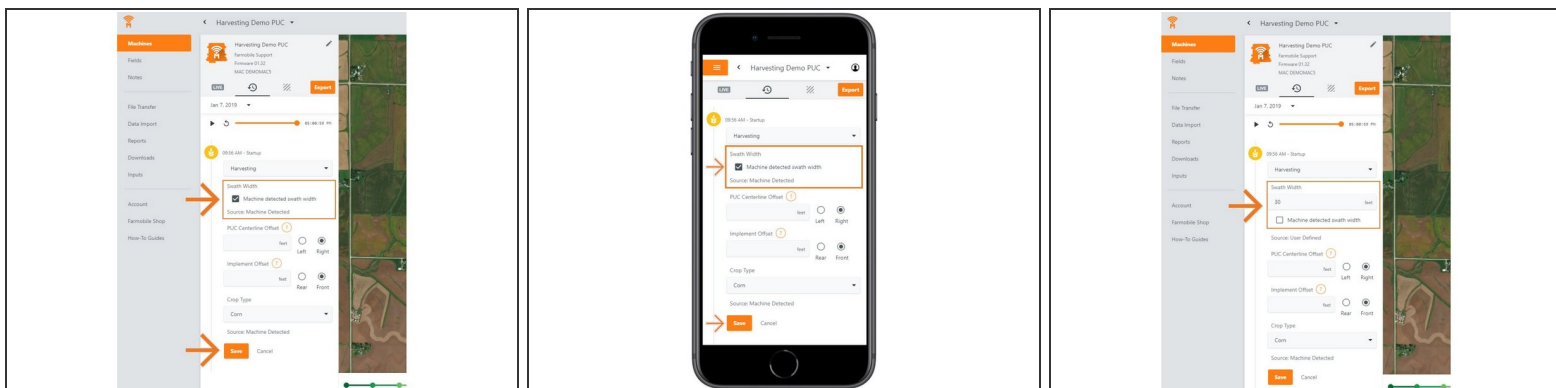

- For activities other than Harvest, type in the correct swath width value and select save.
- For Forage and Harvest activities, the swath width source is always listed to reference.
 - 'Machine Detected': While Harvesting the PUC captured the swath width from the machine. To override these values, un-check the 'Machine detected swath width' checkbox and type in the required swath width value.
 - User Defined: While Harvesting, a user provided the swath width. Adjust the value by typing in the correct swath width.
- Select 'Save' to make the adjustment.